



RS-004 Rotary Drum Fine Screen

## Rotary Drum Fine Screen

Rotary drum screen is operated to remove fine particles in water and wastewater stream. The raw water is feed-in through the inner of the drum and drained off by the difference of the liquid pressure, while the filtration, washing cloth and discharge will be completed due to the rolling action of the drum. The particles and debris are retained on the interior surface of the screen and removed at the opposite side of the raw water feed.

### Purpose

Remove small suspend particles with the size of  $5 \sim 80 \mu\text{m}$  ( $0.005 \sim 0.08 \text{ mm}$ ) in the water and wastewater.

### Applications

- Municipal intake to water treatment.
- Municipal preliminary and primary sewage treatment.
- Sludge separation and dewatering.
- Advance treatment.

### Features

- › Compact footprint.
- › Easy to installation, operation and maintenance.
- › Replaceable filter cloth.
- › No operating interruption even during power failure.
- › Low power consumption (approximately 1/15 of the traditional screen) and operation costs
- › High efficiency.
- › Stainless steel and PP filter cloths are available on demand.



## Equipment Process

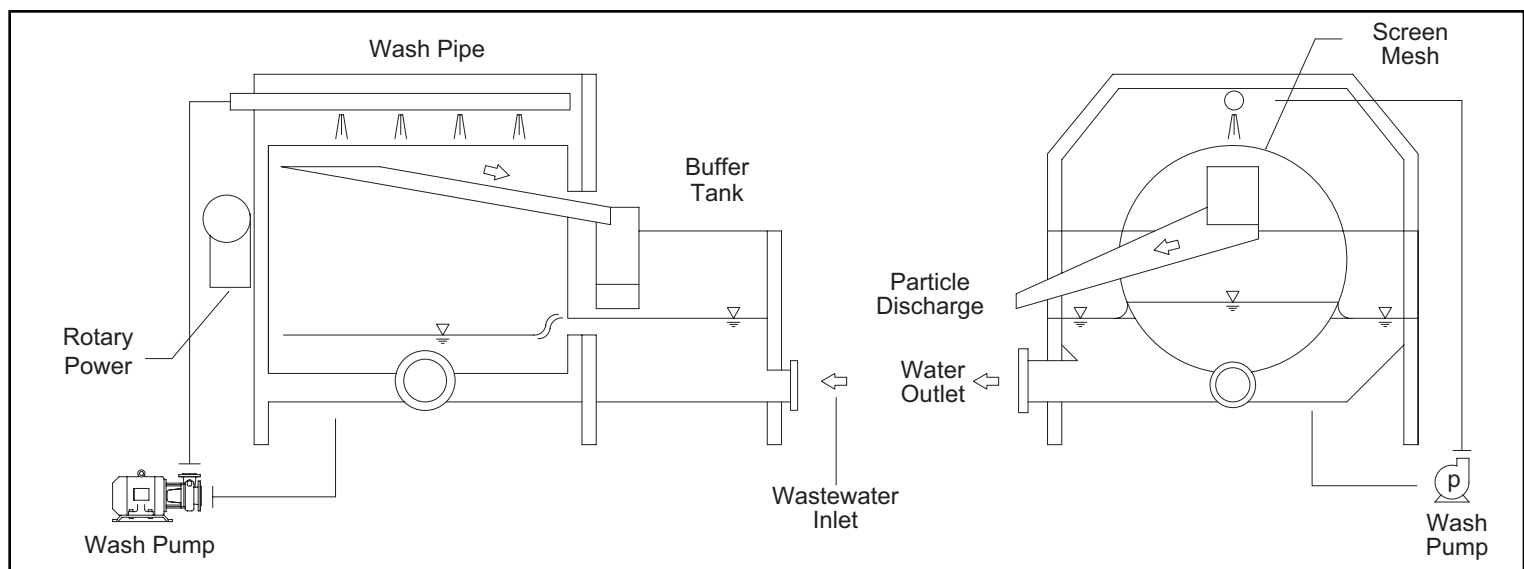

# Equipment Drawings and Section Views

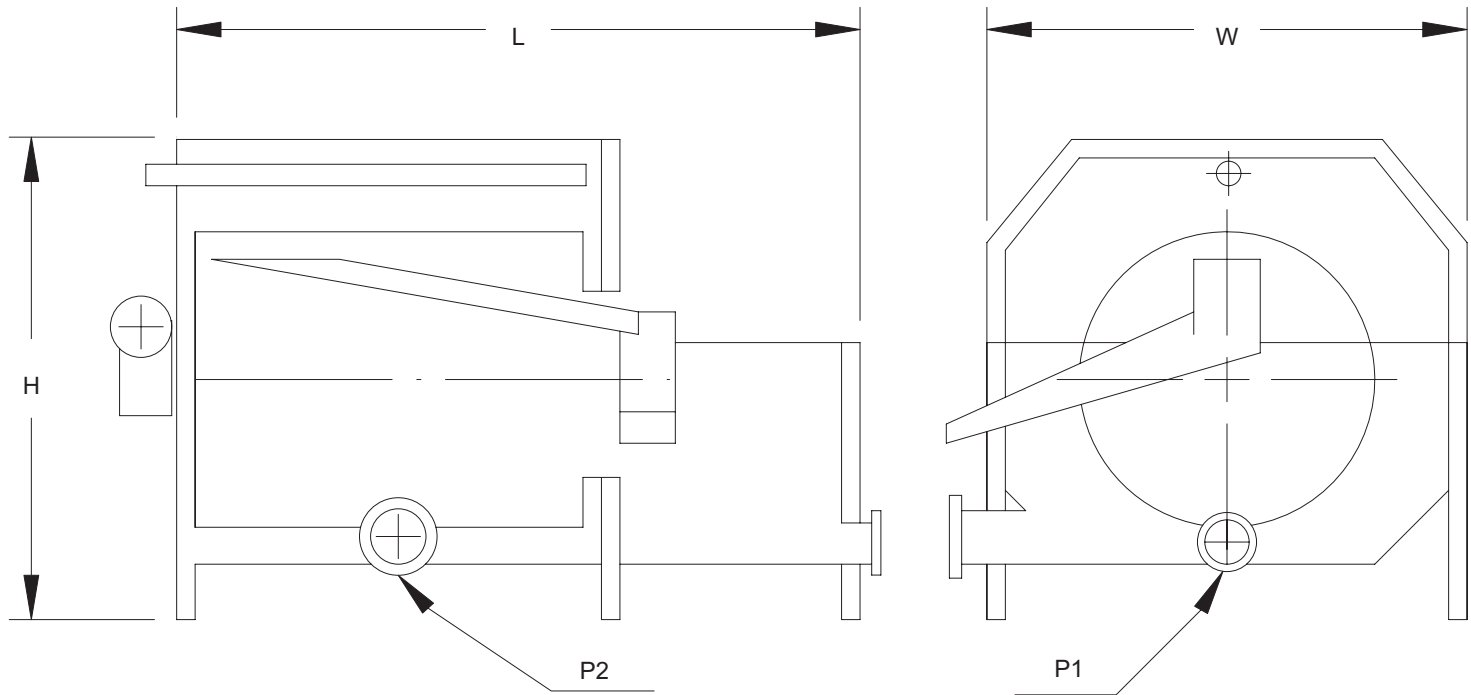

## Rotary Drum Fine Screen

Specifications	Model	Capacity (m <sup>3</sup> /hr)	W (mm)	L (mm)	H (mm)	P1	P2	Power	SUS304 & P.P. 2 ~ 200 mesh
	AS20	5-20	800	1000	800	4"	4"	1 KW	
	AS50	20-50	1000	1400	1000	4"	6"	2 KW	
	AS90	50-90	1200	1600	1200	6"	6"*2	3 KW	
	AS150	90-150	1600	2200	1600	6"*2	8"*2	4.5 KW	P.P. For 200 ~ 600 mesh

